

**ITEM 31. PARKING – PERMIT PARKING – LAWRENCE STREET
ALEXANDRIA**

TRIM RECORD NO: 2014/297929

RECOMMENDATION

It is recommended that the Committee endorse the allocation of parking on the western side of Lawrence Street, Alexandria, as “2P 8am-6pm Mon-Fri Permit Holders Excepted Area 35” between the following points north of Maddox Street:

- (A) 15.7 metres and 114.2 metres (16 car spaces);
- (B) 124.3 metres and 132.3 metres (one car space); and
- (C) 139.2 metres and 237.8 metres (33 60° angled parking spaces).

DECISION

BACKGROUND

In June 2014, the City received a petition signed by residents of 29 properties requesting consideration for 2P permit parking in Lawrence Street, Alexandria between Maddox and Harley Streets.

COMMENTS

In November 2011, the City consulted with residents in Lawrence Street asking for support for the introduction of timed permit parking as part of the Alexandria Parking Trial.

The parking restrictions were proposed in response to residents’ concerns about the difficulty of getting on-street parking following the influx of commuter parking in the streets surrounding the Australian Technology Park site.

At that time, residents in Lawrence Street did not support the timed permit parking proposal. It was noted that the City would monitor parking conditions in the street and reconsider the permit parking proposal if there was strong support from residents in the future.

Parking in Lawrence Street between Maddox and Harley Streets is currently unrestricted.

On-site inspection shows there is a need to provide some timed permit parking to increase parking turnover and improve resident access to on-street parking.

The proposed changes would limit any vehicle which does not have a permit to two (2) hours of parking from 8am to 6pm, Monday to Friday where the signs are installed.

Residents with an Area 35 parking permit will be exempt from the 2-hour time limit.

A two-hour parking limit is preferred for streets in the inner residential areas as it better balances the long-stay parking needs of permit holders with the needs of all households to use parking for visitors, family, carers and tradespeople.

CONSULTATION

In June 2014, the City received a petition signed by residents of 29 properties of Lawrence Street, between Maddox and Harley Streets, supporting timed permit parking.

The City consulted local residents and businesses in the area. There were 122 letters sent out with 14 responses supporting the proposal (not including the original petition) and 25 responses opposing the proposal.

The submissions opposing the proposal were concerned about the loss of unrestricted parking. While the petitioners and submissions supporting the proposal believed the parking change would improve resident access to on-street parking.

Since the majority of residents in support of timed permit parking reside on the western side of this section of Lawrence Street, it is proposed to introduce permit parking to this side of Lawrence Street only. No parking changes are proposed on the eastern side of the street where parking is currently unrestricted. This will allow for drivers who are not eligible for permits and long stay visitors to the area.

FINANCIAL

Funds are available in the current budget.

ATTACHMENTS

Parking – Permit Parking – Lawrence Street Alexandria

Clement Lim, Senior Traffic Engineer

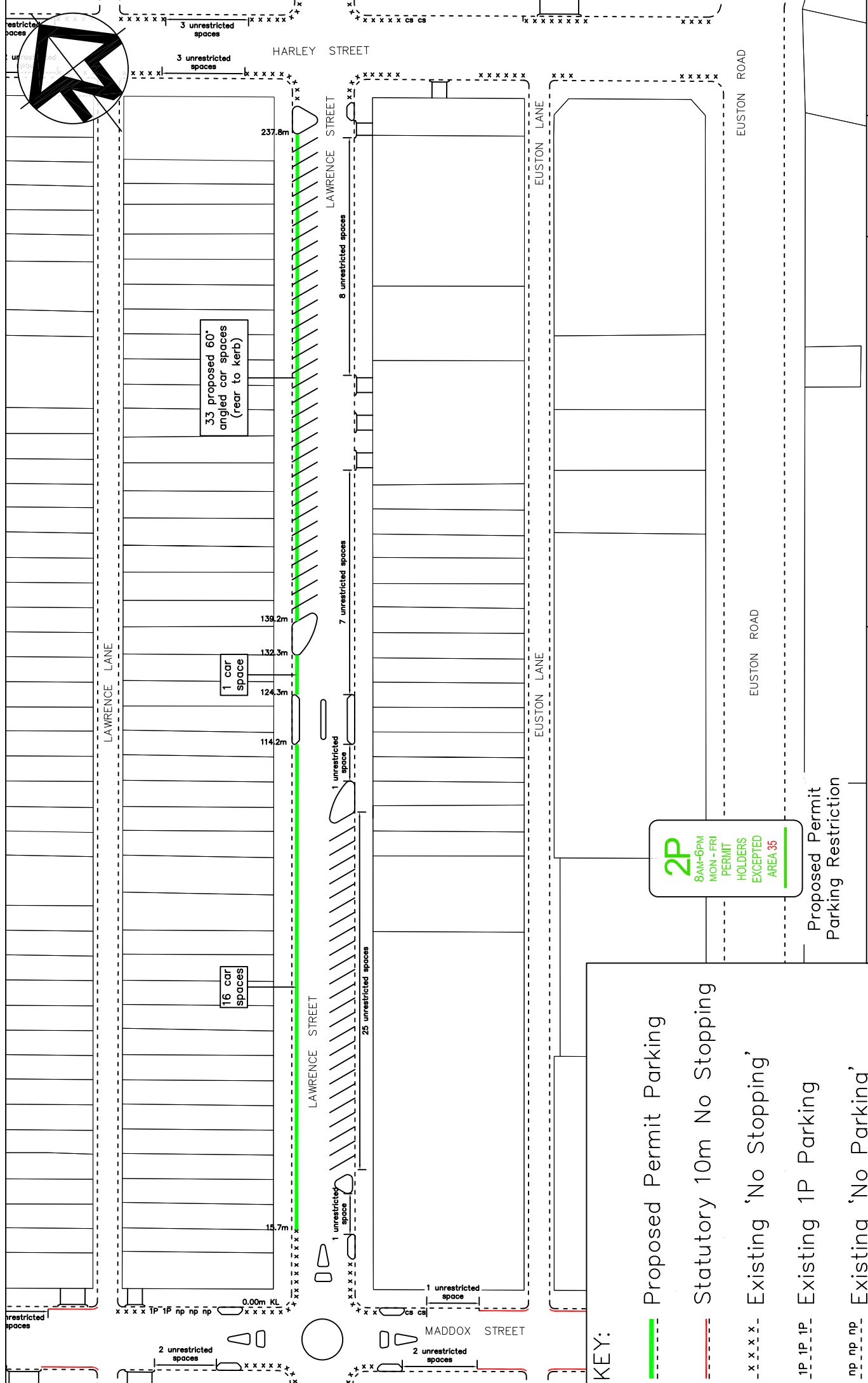

2P
 8AM-6PM
 MON-FRI
 PERMIT
 HOLDERS
 EXCEPTED
 AREA 35

Proposed Permit
 Parking Restriction

- KEY:**
- Proposed Permit Parking
 - Statutory 10m No Stopping
 - x-x-x- Existing 'No Stopping'
 - _1P_1P_ Existing 1P Parking
 - np np np Existing 'No Parking'
 - cs--cs-- Existing Car Share
 - Kerb Line

SCALE: NTS
 DATE: 07/2014
 LawrenceSt_PermitParking_M2H

PROPOSED PERMIT PARKING
 LAWRENCE ST, ALEXANDRIA
 MADDOX TO HARLEY



